



FOR **LEASE**

WAREHOUSE SPACE WITH OUTSIDE STORAGE

7735 EASTERN AVENUE | BALTIMORE, MARYLAND 21224



MACKENZIE
COMMERCIAL REAL ESTATE SERVICES, LLC



PROPERTY OVERVIEW

HIGHLIGHTS:

- 69,000 SF ± warehouse space
- Up to 4.75 acres ± of outside storage (can be leased separately from warehouse)
- Air conditioned warehouse
- Short term leases available
- Excellent visibility
- Easy access to major highways I-695, I-95, I-895
- Close proximity to Downtown Baltimore, the Port of Baltimore and BWI Airport
- Permitted Uses: Most light industrial, warehouse, retail (subject to restrictions), and outside storage uses including equipment storage

AVAILABLE:	69,000 SF ±
IOS:	UP TO 4.75 ACRES ±
DOCKS:	6
DRIVE-INS:	1
ZONING:	BM CT (BUSINESS MAJOR) [COMMERCIAL, TOWN CENTER CORE DIST.]
RENTAL RATE:	NEGOTIABLE

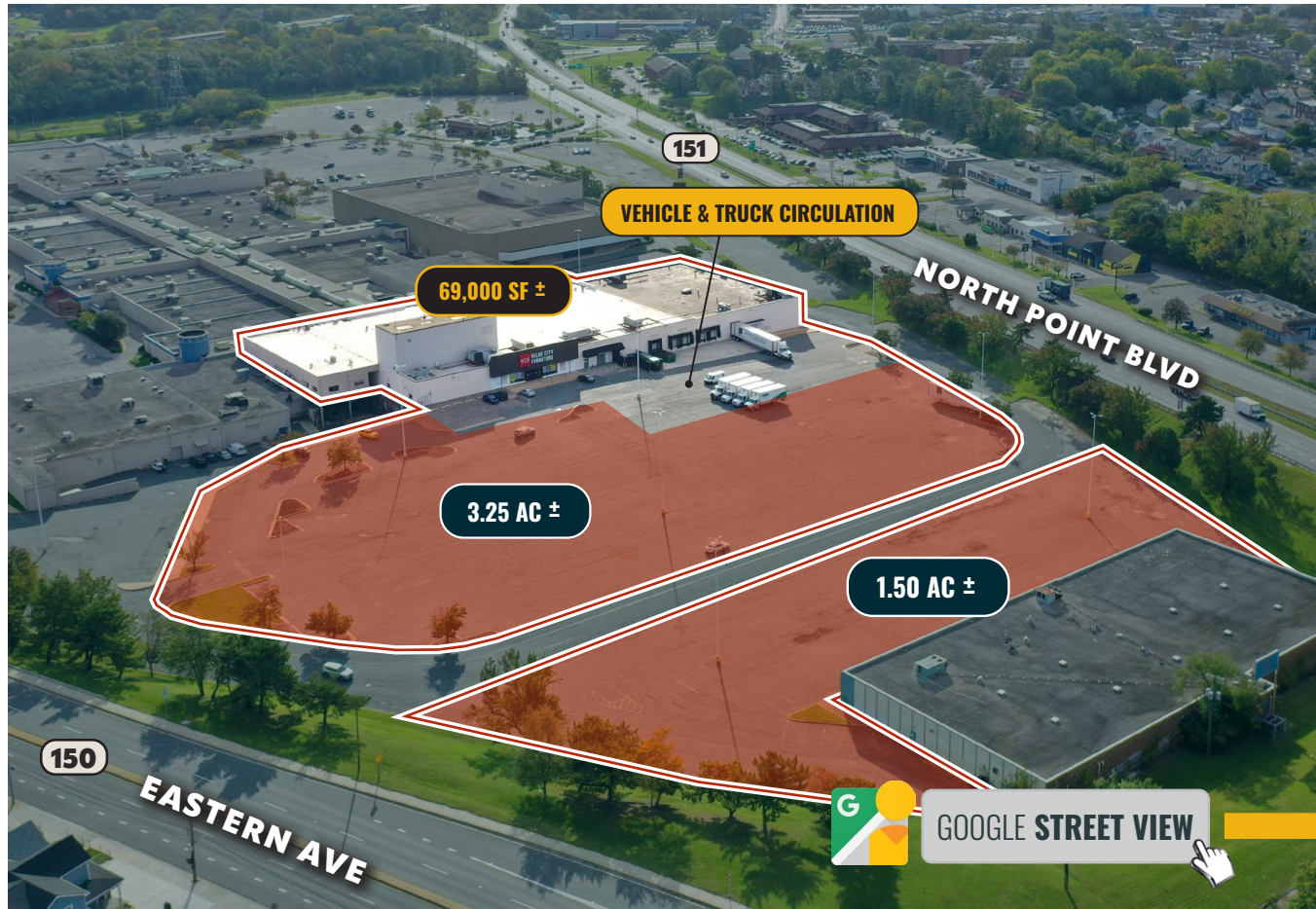

AERIAL: LEASING OPTIONS

OPTION 1:

WAREHOUSE

69,000 SF
WAREHOUSE SPACE

OPTION 2:

WAREHOUSE W/ IOS

69,000 SF
WAREHOUSE SPACE
WITH UP TO **4.75 ACRES**
STORAGE YARD

OPTION 3:

IOS

UP TO **4.75 ACRES**
STORAGE YARD



FLOOR PLAN

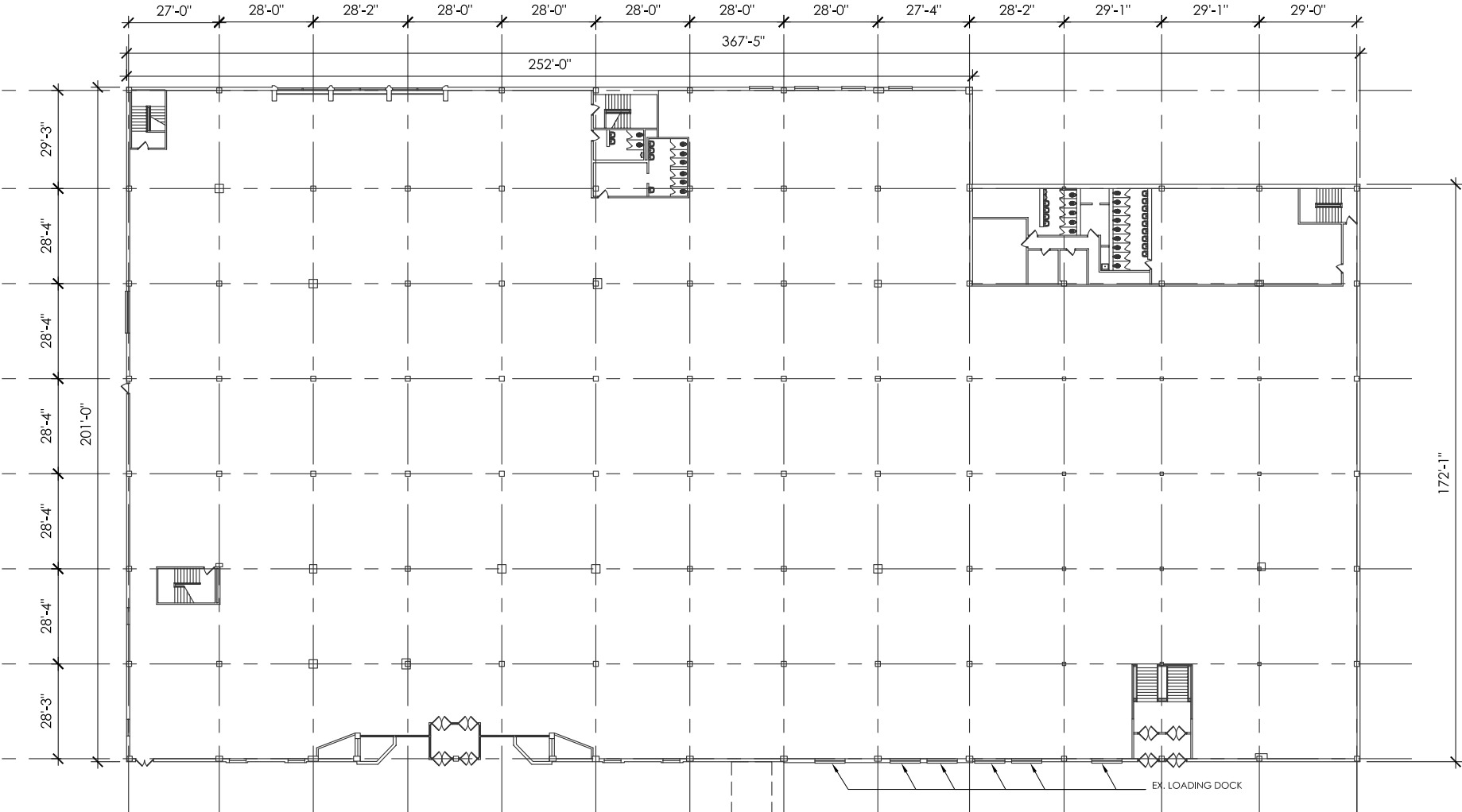

NOTE: THIS DRAWING HAS NOT BEEN FIELD VERIFIED AND IS MEANT FOR GENERAL LEASING PURPOSES ONLY.

TOTAL SQUARE FOOTAGE: APPROX. 69,000 SF

69,000 SF ±

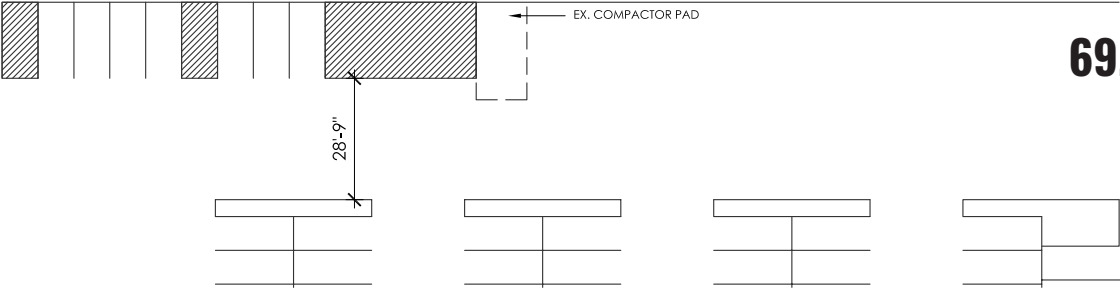

LOCAL BIRDSEYE

THE PORT OF BALTIMORE

BALTIMORE

VEHICLE & TRUCK CIRCULATION

NORTH POINT BLVD

151

1.50 AC ±

3.25 AC ±

69,000 SF ±

EASTERN AVE

150



TRADE AREA

DRIVING DISTANCE TO:

INTERSTATE 695
1.1 MILES
3 MIN. DRIVE

INTERSTATE 95
1.9 MILES
4 MIN. DRIVE

INTERSTATE 895
2.8 MILES
6 MIN. DRIVE

PORT OF BALTIMORE
1706
Helen Delich Bentley
6.0 MILES
10 MIN. DRIVE
(SEAGIRT MARINE TERMINAL)

BWI
BALTIMORE/WASHINGTON INTERNATIONAL
Thurgood Marshall AIRPORT
15.8 MILES
18 MIN. DRIVE

BALTIMORE, MD
6.3 MILES
19 MIN.

WASHINGTON, DC
46.5 MILES
1 HR. 2 MIN.

PHILADELPHIA, PA
98.4 MILES
1 HR. 38 MI

RICHMOND, VA
159.0 MILES
2 HRS. 32 MIN.



FOR MORE INFO **CONTACT:**



DANIEL HUDAK, SIOR
SENIOR VICE PRESIDENT & PRINCIPAL
443.573.3205
DHUDAK@mackenziecommercial.com



ANDREW MEEDER, SIOR
SENIOR VICE PRESIDENT & PRINCIPAL
410.494.4881
AMEEDER@mackenziecommercial.com



MATTHEW CURRAN, SIOR
SENIOR VICE PRESIDENT & PRINCIPAL
443.573.3203
MCURRAN@mackenziecommercial.com



VISIT **PROPERTY PAGE** FOR MORE INFORMATION.



MACKENZIE
COMMERCIAL REAL ESTATE SERVICES, LLC

443-573-3200
111 S. Calvert Street
Baltimore, MD 21202

OFFICES IN: ANNAPOLIS, MD **BALTIMORE, MD** BEL AIR, MD COLUMBIA, MD LUTHERVILLE, MD CHARLOTTESVILLE, VA

www.MACKENZIECOMMERCIAL.com

No warranty or representation, expressed or implied, is made as to the accuracy of the information contained herein, and same is submitted subject to errors, omissions, change of price, rental or other conditions, withdrawal without notice, and to any specific listing conditions imposed by our principals.