



SYKESVILLE BUSINESS CENTER

53-55 LIBERTY ROAD | SYKESVILLE, MARYLAND 21784

**RETAIL SPACE
FOR
LEASE**

**INLINE
AND END CAP
RETAIL SUITES
AVAILABLE!**

**CONSTRUCTION
NEARING
COMPLETION!**



MACKENZIE
RETAIL

PROPERTY OVERVIEW

HIGHLIGHTS:

- 1st Floor Retail spaces ranging from 1,438 SF (inline) to 1,452 SF (end cap)
- Residential apartments on 2nd Floor
- Highly visible location with 790 ft. ± of frontage on heavily trafficked Liberty Road/Rt. 26 (26,980 vehicles per day)
- Across from new Ryan Homes
- 5 minute drive to Eldersburg
- Easy access to Route 97 (New Washington Rd)

BUILDING 'A':	15,846 SF ± (1ST FLOOR RETAIL)
BUILDING 'B':	15,846 SF ± (1ST FLOOR RETAIL)
DELIVERY:	JANUARY 1, 2025
LOT SIZE:	6.58 ACRES ±
TRAFFIC COUNT:	26,980 AADT (LIBERTY RD/RT. 26)
ZONING:	C-2 (COMMERCIAL MEDIUM INTENSITY DIST.)
RENTAL RATE:	NEGOTIABLE



FLOOR PLANS: BUILDING 'A'

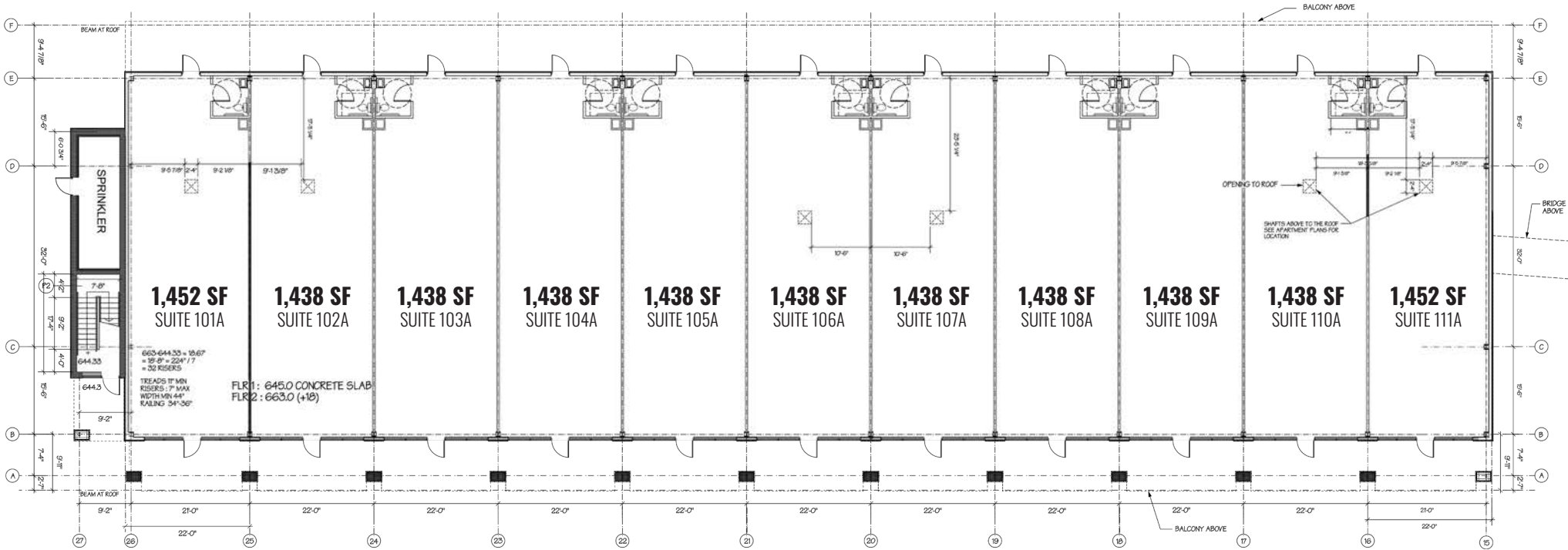

1ST FLOOR (RETAIL)

FLOOR PLANS: BUILDING 'B'

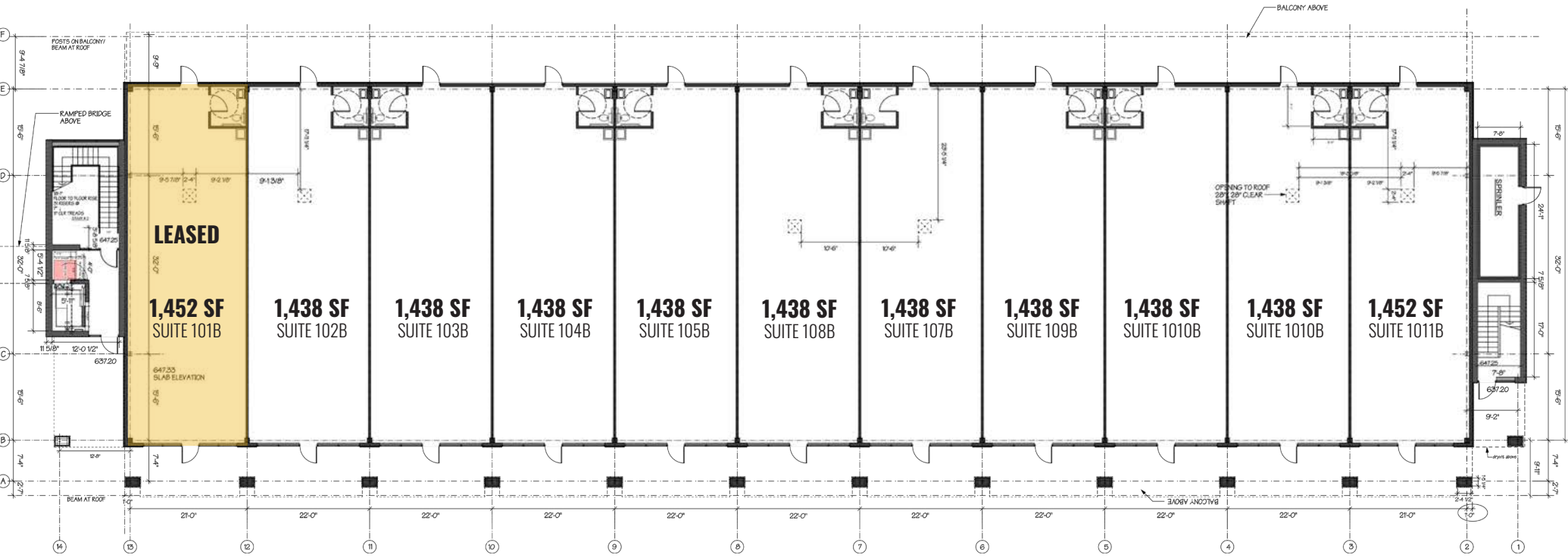

1ST FLOOR (RETAIL)

LOCAL TRADE AREA



SAVAGE
DANCE COMPANY

Blackbird
CROSSFIT

Blackbird
CROSSFIT

ROYAL FLUSH
AMUSEMENTS

ENTERPRISE ST

KLEE MILL RD

26

W OLD LIBERTY RD

JOHN DEERE
FINCH TURF

WHATADAY
CAFE
Gourmet
Wine & Spirits

CENTURY HIGH SCHOOL

LIBERTY RD

Bobcat

HIGH'S

NEW
LIBERTY PLACE
55+ CONDOS BY
Ryan
Homes

LINTON SPRINGS
ELEM. SCHOOL

MANTE

SITE



REGIONAL TRADE AREA



DEMOGRAPHICS

2024

RADIUS: **1 MILE** **3 MILES** **5 MILES**

RESIDENTIAL POPULATION



1,184	18,336	48,366
-------	--------	--------

DAYTIME POPULATION



2,275	15,930	38,240
-------	--------	--------

AVERAGE HOUSEHOLD INCOME



\$208,816	\$178,804	\$173,928
-----------	-----------	-----------

NUMBER OF HOUSEHOLDS



385	6,455	17,206
-----	-------	--------

MEDIAN AGE



43.5	42.1	42.2
------	------	------

[FULL DEMOS REPORT](#)

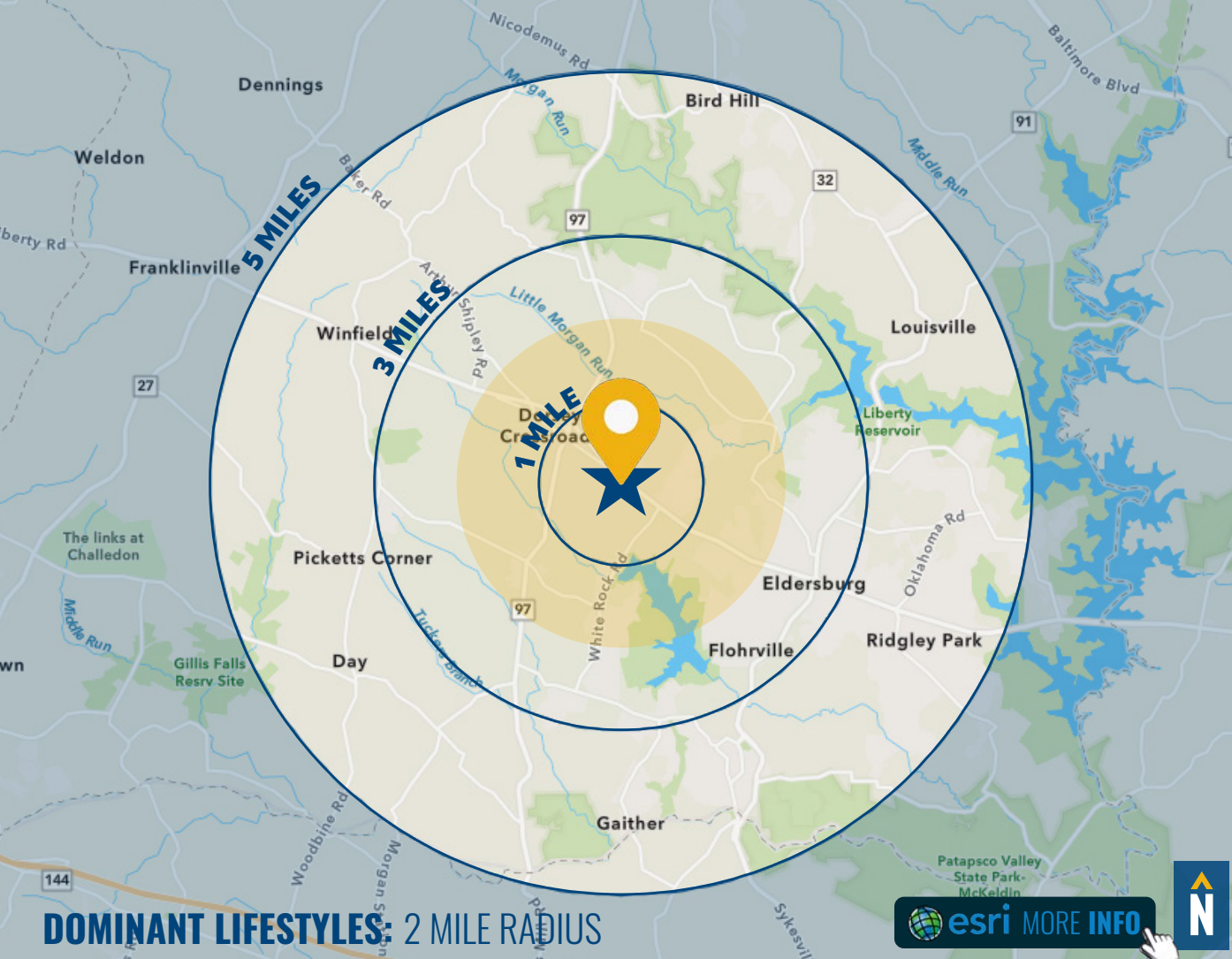

DOMINANT LIFESTYLES: 2 MILE RADIUS

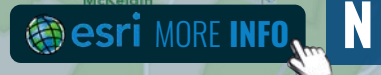

71%
SAVVY
SUBURBANITES

These residents are well educated, well read and well capitalized. Largely empty nesters, they have a suburban lifestyle, but also enjoy good food and wine, plus the amenities of the city's cultural events.

Median Age: **45.1**
Median Household Income: **\$108,700**

17%
PROFESSIONAL
PRIDE

These well-educated consumers are career professionals with an annual household income more than twice the US level. Their homes tend to be equipped with home gyms and in-home theaters.

Median Age: **40.8**
Median Household Income: **\$138,100**

12%
BOOMBURBS

Rapid growth distinguishes this affluent market, made up of well-educated, young professionals with families. Well connected, they own the latest devices and understand how to use them efficiently.

Median Age: **34.0**
Median Household Income: **\$113,400**

FOR MORE INFO **CONTACT:**



DENNIS BOYLE

SENIOR VICE PRESIDENT

443.798.9339

DBOYLE@mackenziecommercial.com



CHRIS WALSH

SENIOR VICE PRESIDENT

410.494.4857

CWALSH@mackenziecommercial.com



GRAHAM SEVY

REAL ESTATE ADVISOR

410.830.1399

GSEVY@mackenziecommercial.com



VISIT **PROPERTY PAGE** FOR MORE INFORMATION.



MACKENZIE

COMMERCIAL REAL ESTATE SERVICES, LLC

410-821-8585

**2328 W. Joppa Road, Suite 200
Lutherville, MD 21093**

OFFICES IN: ANNAPOLIS, MD BALTIMORE, MD BEL AIR, MD COLUMBIA, MD **LUTHERVILLE, MD** CHARLOTTESVILLE, VA

www.MACKENZIECOMMERCIAL.com

No warranty or representation, expressed or implied, is made as to the accuracy of the information contained herein, and same is submitted subject to errors, omissions, change of price, rental or other conditions, withdrawal without notice, and to any specific listing conditions imposed by our principals.