



INDUSTRIAL/SERVICE BUILDING

8150 CRYDEN WAY | DISTRICT HEIGHTS, MARYLAND 20747

FOR
SALE



MACKENZIE

COMMERCIAL REAL ESTATE SERVICES, LLC

PROPERTY OVERVIEW

HIGHLIGHTS:

- 9,804 SF ± building on .458 Acres ±
- 1,800-2,000 SF ± of existing office space
- Excellent clear heights
- 5 oversized drive-in doors
 - » Bays 1-4: 12' w x 12' h
 - » Bay 5: 14' w x 16' h
- LED lighting in warehouse
- Easily able to multi-tenant
- IE (Industrial Employment) zoning
- Easy access to I-495/Capital Beltway
- Close proximity to Joint Base Andrews

BUILDING SIZE:

9,804 SF ±

LOT SIZE:

.458 ACRES ±

CLEAR HEIGHT:

19'-20' ±

DRIVE-INS:

5 (OVERSIZED)

ZONING:

IE (INDUSTRIAL EMPLOYMENT)

SALE PRICE:

NEGOTIABLE

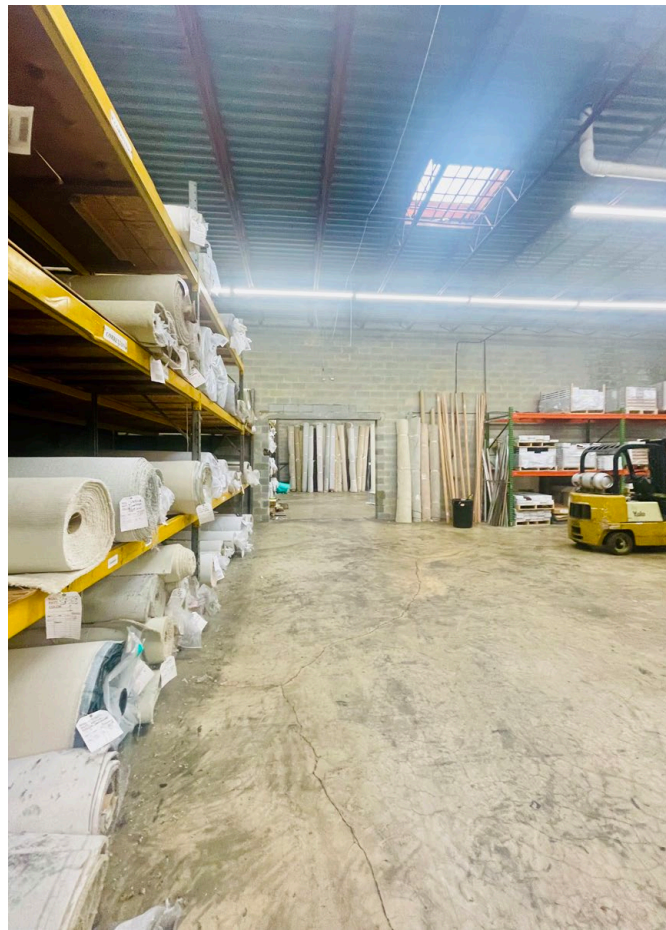

AERIAL

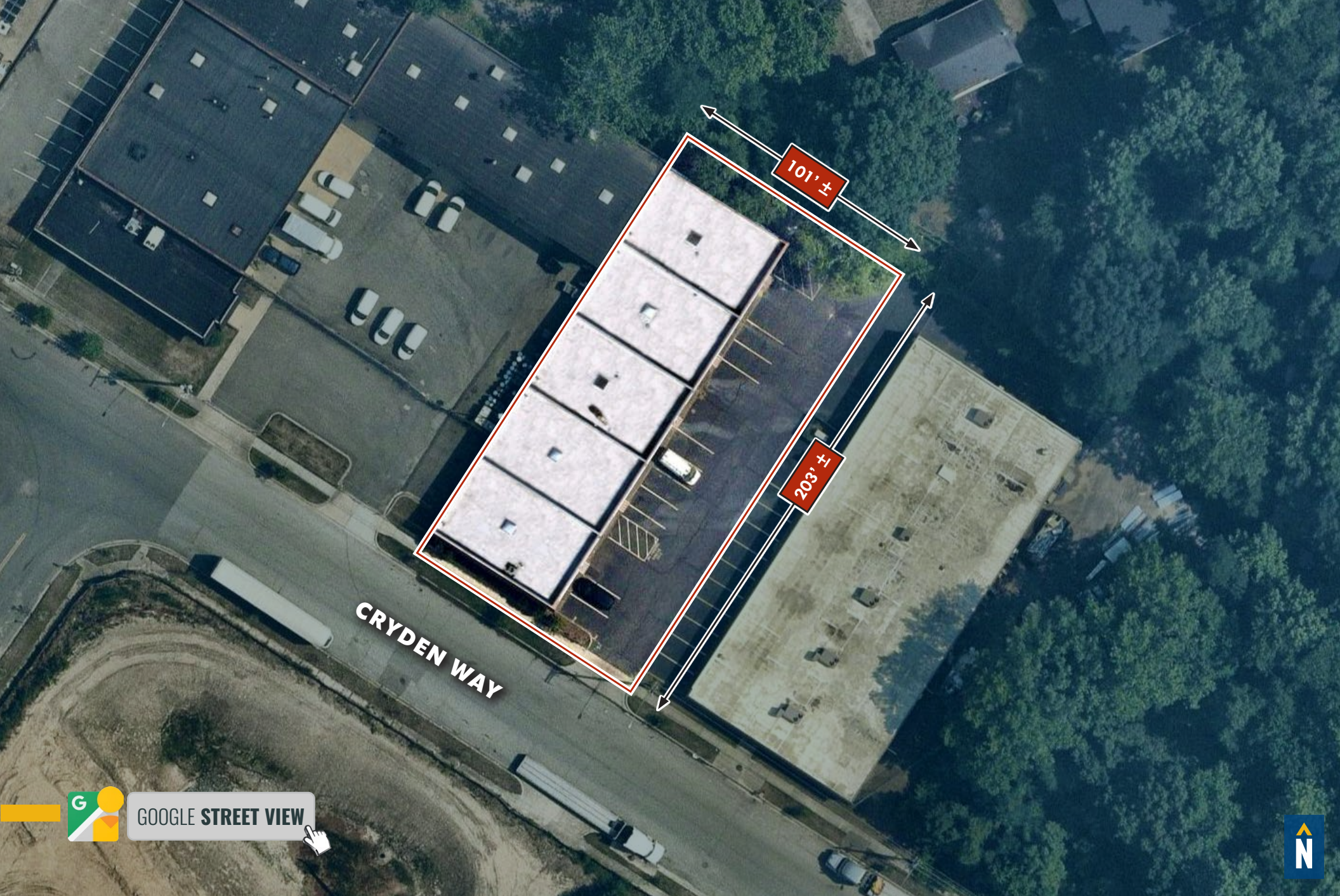

GOOGLE STREET VIEW



FLOOR PLAN

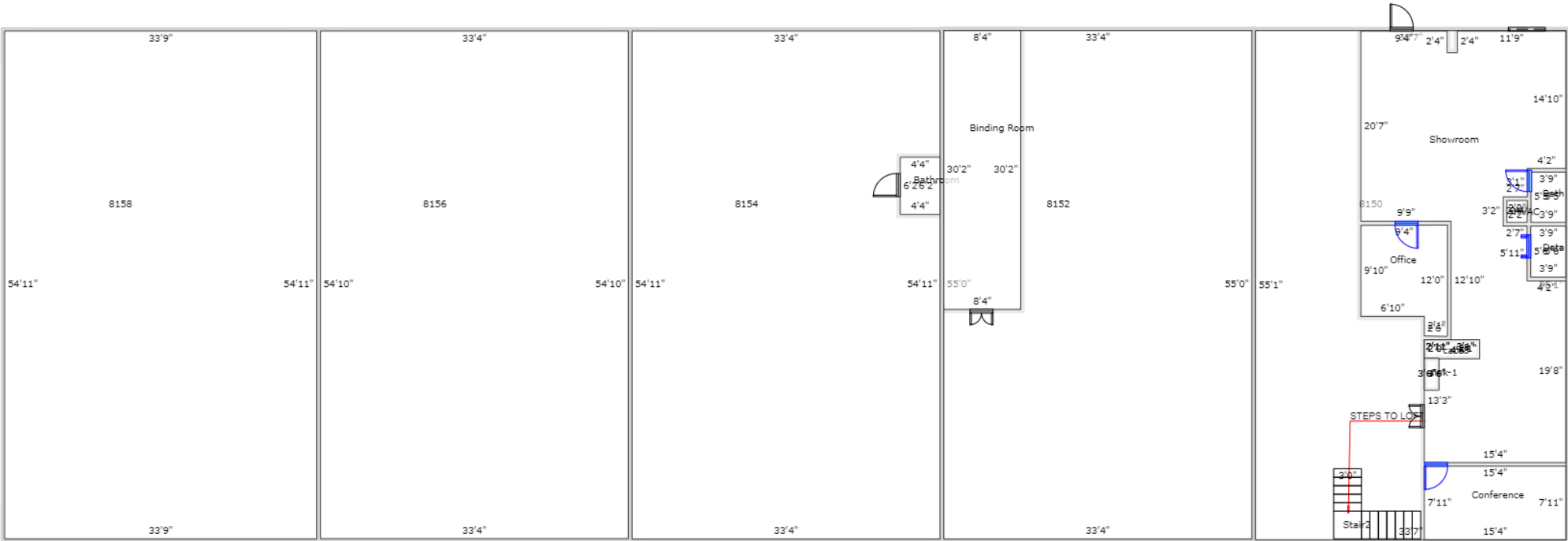

TRADE AREA

DRIVING DISTANCE TO:

4 0.9 MILES
4 MIN. DRIVE

INTERSTATE 495 1.4 MILES
5 MIN. DRIVE

4 4.8 MILES
9 MIN. DRIVE

AMERICA'S AIRFIELD
5.0 MILES
15 MIN. DRIVE

REAGAN NATIONAL
15.1 MILES
24 MIN. DRIVE

WASHINGTON, DC 14.7 MILES
27 MIN.

BALTIMORE, MD 45.1 MILES
45 MIN.

RICHMOND, VA 115.0 MILES
1 HR. 40 MIN.

PHILADELPHIA, PA 140.0 MILES
2 HRS. 30 MIN.



FOR MORE INFO CONTACT:



BRYAN HERR

VICE PRESIDENT

443.875.7505

BHERR@mackenziecommercial.com



OLIVER FRYER

VICE PRESIDENT

410.427.0454

OFRYER@mackenziecommercial.com



JUSTIN VIRTS

REAL ESTATE ADVISOR

703.727.1742

JVIRTS@mackenziecommercial.com



ANDREW MEEDER, SIOR

SENIOR VICE PRESIDENT & PRINCIPAL

410.494.4881

AMEEDER@mackenziecommercial.com



VISIT **PROPERTY PAGE** FOR MORE INFORMATION.



MACKENZIE

COMMERCIAL REAL ESTATE SERVICES, LLC

410-974-9336

410 Severn Avenue

Annapolis, MD 21403

OFFICES IN: **ANNAPOLIS, MD** BALTIMORE, MD BEL AIR, MD COLUMBIA, MD LUTHERVILLE, MD CHARLOTTESVILLE, VA

www.MACKENZIECOMMERCIAL.com

No warranty or representation, expressed or implied, is made as to the accuracy of the information contained herein, and same is submitted subject to errors, omissions, change of price, rental or other conditions, withdrawal without notice, and to any specific listing conditions imposed by our principals.