



EXECUTIVE PLAZA II

11350 MCCORMICK ROAD | HUNT VALLEY, MD 21031

FOR
SUBLEASE



MACKENZIE

COMMERCIAL REAL ESTATE SERVICES, LLC

PROPERTY OVERVIEW

HIGHLIGHTS:

- Turn Key Class A Office Space
- Centrally located in Hunt Valley right off I-83
- Amenities include gym, deli, post office, salon, Daycare, conference room and many more.



AVAILABLE:	SUITE 401: 4,232 SF
PARKING:	3.38/1,000 SF
STORIES:	8
RENTAL RATE:	\$23.85/SF, FS



GOOGLE STREET VIEW



FLOOR PLAN

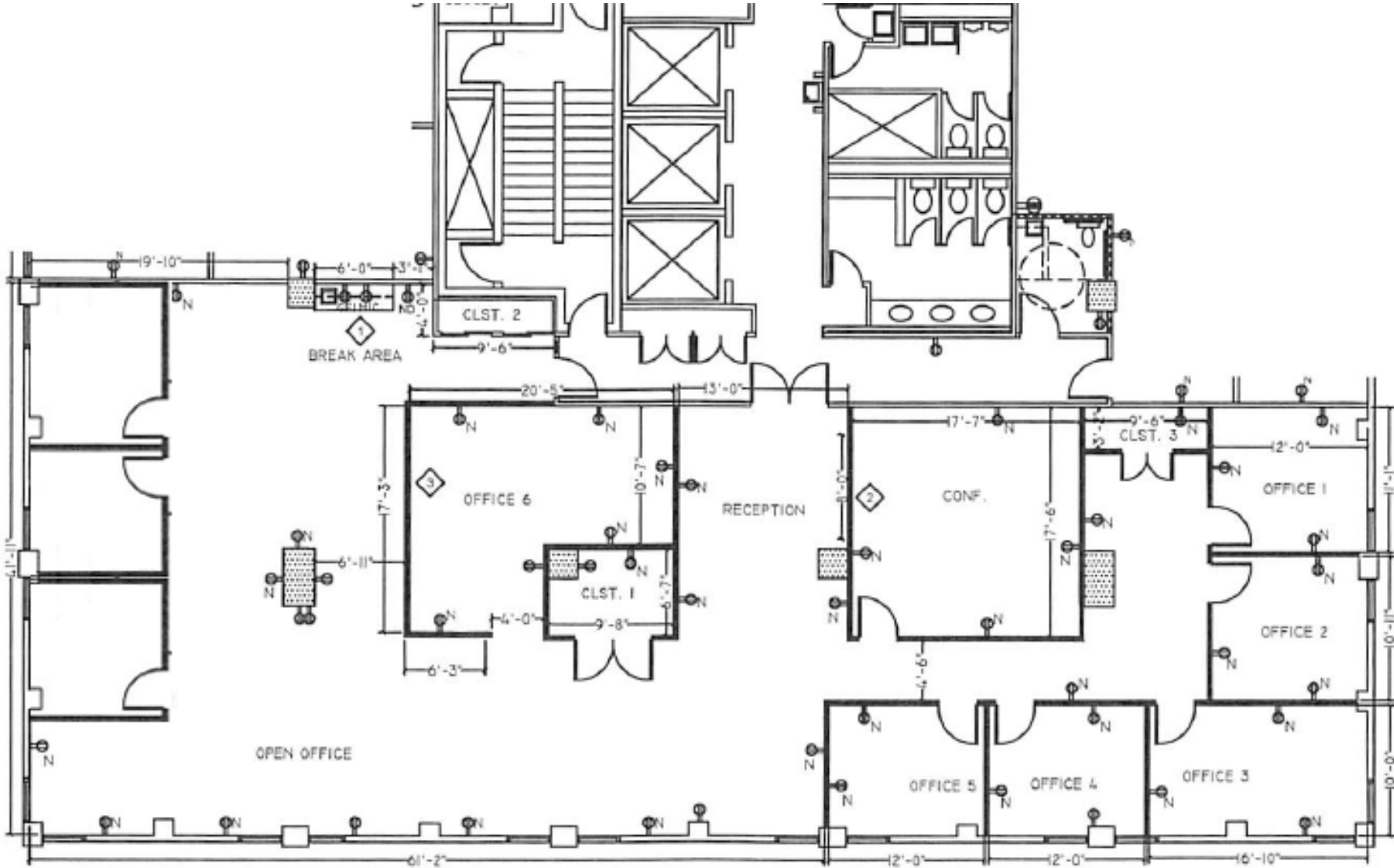

INTERIOR PHOTOS



DEMOGRAPHICS

2024

RADIUS:

1 MILE

3 MILES

5 MILES

RESIDENTIAL POPULATION



882

12,671

31,054

DAYTIME POPULATION



19,891

56,035

91,943

AVERAGE HOUSEHOLD INCOME



\$138,752

\$148,515

\$170,641

NUMBER OF HOUSEHOLDS



850

12,600

27,798

MEDIAN AGE



51.7

43.5

43.5

[FULL DEMOS REPORT](#)

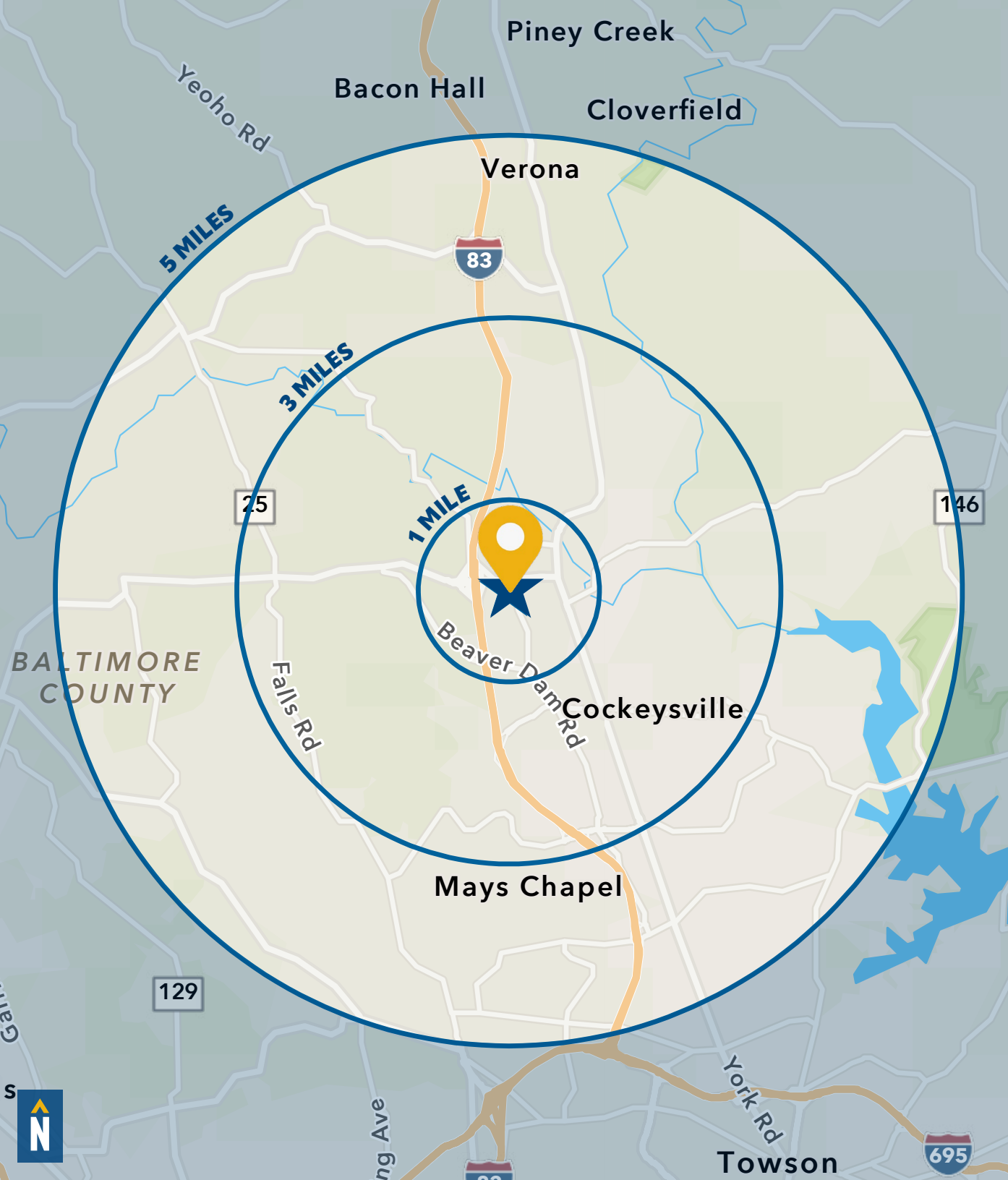

FOR MORE INFO CONTACT:



DYLAN BOZEL
REAL ESTATE ADVISOR

410.494.4896
DZOZEL@mackenziecommercial.com



HENSON FORD
VICE PRESIDENT

410.494.6657
HFORD@mackenziecommercial.com



MACKENZIE

COMMERCIAL REAL ESTATE SERVICES, LLC

410-821-8585
2328 W. Joppa Road, Suite 200
Lutherville, MD 21093

OFFICES IN: ANNAPOLIS, MD BALTIMORE, MD BEL AIR, MD COLUMBIA, MD LUTHERVILLE, MD CHARLOTTESVILLE, VA

www.MACKENZIECOMMERCIAL.com



VISIT **PROPERTY PAGE** FOR MORE INFORMATION.

No warranty or representation, expressed or implied, is made as to the accuracy of the information contained herein, and same is submitted subject to errors, omissions, change of price, rental or other conditions, withdrawal without notice, and to any specific listing conditions imposed by our principals.